

DIAMOND LEVEL



PLATINUM LEVEL

NuFloors	BC Hydro Power Smart
T&N Roofing	Future Energy Resources
Hand to Stone	Riverside Energy Systems
RM Insulation Inc.	OK Builders Supplies Ltd.
Euroshield Roofing	Norgaard Ready Mix Ltd.
Emco Corporation	All Weather Windows Ltd.
Stucco by Tom Inc.	Ground Sense Landscaping
Landygo Drywall Ltd.	Homeowner Protection Office
Robinson Masonry Ltd.	M. Milligan and Associates Ltd.

GOLD LEVEL

Winroc	90 Degree Plumbing Inc.
RDF Electric	BA Dawson Blacktop Ltd.
Light Your World	Clean Energy Developments
Cloverdale Paint	Innotech Windows Canada Inc.
Sunwise Systems	Commercial Construction Supply
Kamloops Klosets	The Ensuite Kitchen and Bath Showroom
Stereo Warehouse	Rapid Cool Heating and Refrigeration Inc.
Stobbe Excavating Ltd.	Pulse Group Media & Communications Ltd.
Trout Creek Enterprises	Optimum Air Heating & Cooling/Sun Solutions

SILVER LEVEL

Cultured Stone	Attention to Detail Painting
Sanyo of Canada	Steels Industrial Product Ltd.
Kamloops Truss Ltd.	Noremac Concrete Pumping
1-800-GOT-JUNK?	Napoleon Fireplaces & Grills
Kamloops Daily News	HUB International Barton Insurance
Wesco Distribution Inc.	Conasys Consumer Assurance Systems Inc.
Kim Wiest Contracting Ltd.	Mercury Media Inc. Fine Decorative Painting

COPPER LEVEL

K-Rod	R U Green Consulting
M3 Steel	Venmar Ventilation Inc.
Day4 Energy	Southgate Electric Ltd.
Big Stone Inc.	Fulton & Company LLP
E.H. Price Ltd.	Royal Bank of Canada
Cajun Mouldings	Universal Reproductions
Salto Waterworks	BMO Bank of Montreal
Coster and Singer	Ener-West Engineering Inc.
Century Glass Ltd.	Peace of Mind Systems Ltd.
Pushor Mitchell LLP	Construction Safety Network
Warner Rentals Ltd.	City Furniture & Appliances Ltd.
Mader & Associates	Anchor Construction Services Ltd.
Shaw Cable Systems	Abco Waterproofing & Sundecks Inc.
The Fireplace Centre	Moulding and Millwork Door Division
Shine Energy Systems	

FRIENDS LEVEL

Lordco	Action Toilet Rentals
Taymor	BC Safety Authority
Richarsons	Mission Building Co.
Jeff Mann	Laughing Swan Farms
Ski Masonry	EECOL Electric Corp.
Ortech Lighting	Westwold View Farms
Nedco (Vernon)	Mike Leemis Carpentry
Kemp Concrete	EB Horsman (Kamloops)
Conroy Exteriors	Roots to Shoots Nursery
DCS Consulting	Shur-View Concrete Ltd.
HPF Engineering	Greenvale Construction
The Dream Team	Future Energy Resources
DSM Electric Ltd.	Wilkinson Steel & Metals
Ron Hall Trucking	Sun Valley Deck & Railing
Big Steel Box.com	See Thru Window Cleaners
Jardines Turf Farm	Kamloops Powder Coatings
Flynn Mirtle Moran	B. Coombs Construction Ltd.
K-West Mechanical	New-Tech Concrete Solutions
Trow Associates Inc.	Thompson Valley Sand and Gravel



green dream home

TOUR GUIDE

1858 IRONWOOD TERRACE



greendreamhome.ca



Inside this tour guide you will find the floor plans for the Green Dream Home. Please follow the route that has been set out for you.

All materials related to the tour are downstairs as you exit. Please feel free to take what you like. If you wish to recycle your tour guide, please leave it in the recycle bin upon exit.

PRESENTING SPONSORS



Central Interior
Canadian Home Builders' Association
921C Laval Crescent
Kamloops, BC V2C 5P4
Phone: 250.828.1844



You could **WIN** this home!
Buy your Dream Home Lottery tickets
and help the Y build strong kids



Funded in part by
Southern Interior
DEVELOPMENT INITIATIVE TRUST



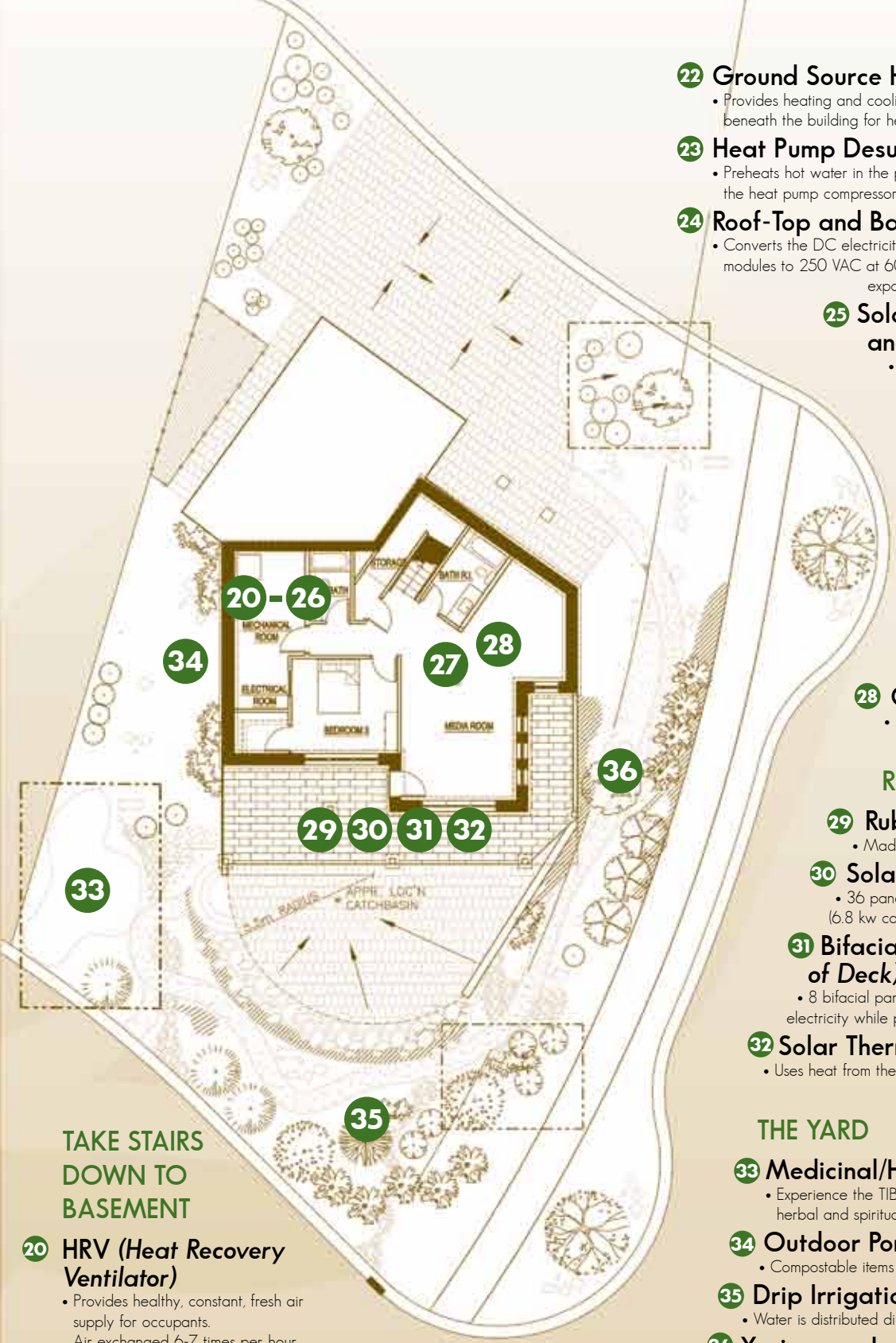
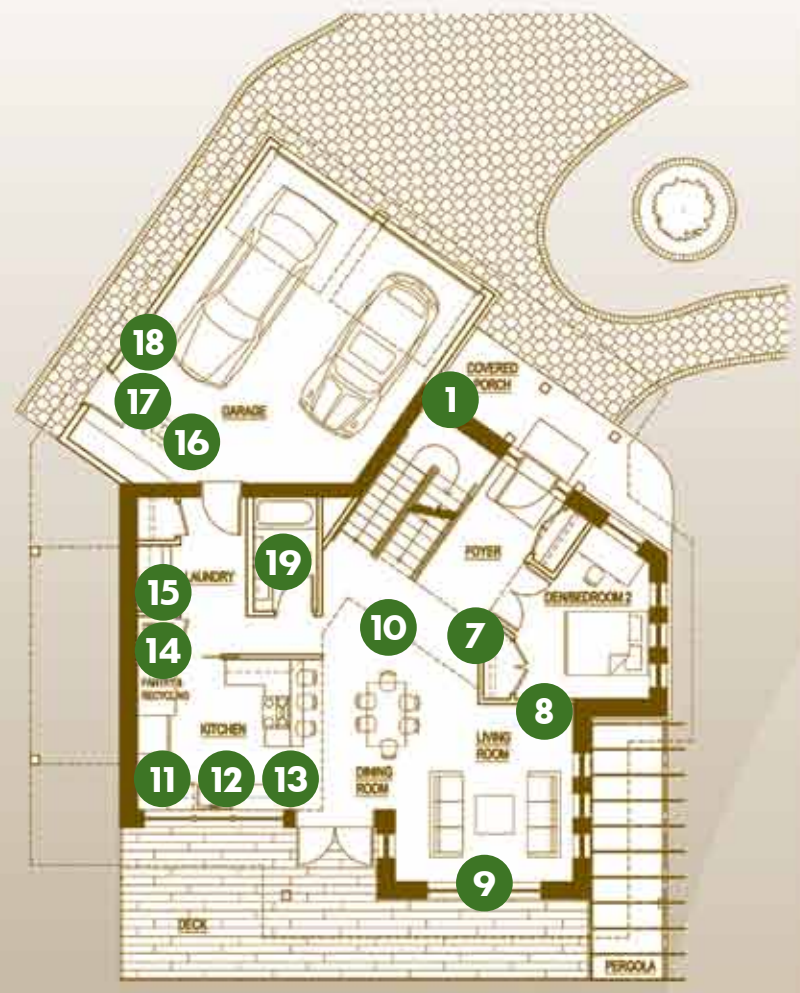

ENTRANCE ON MAIN FLOOR

- 1 Home Automation System**
 - Controls electricity and heat in the home among many other things.

TAKE STAIRS UP

- 2 Interior Railing**
 - Recycled Rebar.
- 3 Triple Glazed Windows (Low-E)**
 - Low-E coating reflects heat from the furnace back into the home (in cold seasons).
- 4 Horizon Paint (Throughout House)**
 - Enviro-Friendly, low VOC (Volatile Organic Compounds) paint which is Green Seal® Certified.
- 5 Cast-Iron Sink**
 - Made out of 93% reclaimed material, faucet provides 30% water savings.
- 6 ECO Tile in European Tiled Shower**
 - Tile is created using an environmentally friendly process and the glaze is free of toxins.
 - Shower head provides 30% water savings.

TAKE STAIRS DOWN TO MAIN LEVEL

- 7 Interior Water Feature**
 - Acts as humidifier.
- 8 Electric Fireplace**
 - The house has no gas as to reduce the carbon footprint.

- 9 Blinds**
 - South facing automated window blinds close as the sun is shining, reducing the amount of heat going into the home.
- 10 Cork Flooring (throughout house)**
 - Cork is considered ecological friendly - cork trees are fast growing and continue growing after cork removal.
- 11 Bamboo Cupboards**
 - Urea Formaldehyde free product and low-emitting material and is made of 100% recycled materials.
- 12 Fridge (no freezer)**
 - Much more energy efficient than a fridge/freezer combination.
- 13 LED and Compact Fluorescent Lighting (throughout house)**
 - LED light bulbs use only 2-10 watts of electricity, lasting up to 10 times as long as compact fluorescents.
- 14 Dryer Cabinet**
 - An air intake and outtake feature allows clothes to dry naturally.
- 15 Highly Efficient Washer & Dryer**
 - EnerGuide rated.
- 16 Two Hybrid Vehicle Plug-Ins**
- 17 Small Energy Efficient Chest Freezer**
- 18 Recycling Bin**
 - Provided to encourage recycling.
- 19 Toilet**
 - Dual flush toilet for water saving (4,000 gallons/year).

TAKE STAIRS DOWN TO BASEMENT

- 20 HRV (Heat Recovery Ventilator)**
 - Provides healthy, constant, fresh air supply for occupants.
 - Air exchanged 6-7 times per hour.
- 21 Dual Hot Water Tanks**
 - Primary hot water tank stores hot water heated by the solar thermal system, desuperheater system, and drain water heat recovery system.
 - Secondary hot water tank used electric heat to boost hot water to operating temperatures at times when heat from the solar hot water and desuperheater systems is not sufficient.

- 22 Ground Source Heat Pump**
 - Provides heating and cooling for the home using geothermal ground loops beneath the building for heat retrieval and storage.
- 23 Heat Pump Desuperheater**
 - Preheats hot water in the primary hot water tank by recovering waste heat from the heat pump compressor.
- 24 Roof-Top and Balcony PV System Inverters**
 - Converts the DC electricity harvested from the roof mounted solar electric modules to 250 VAC at 60 Hz for connection to the home's electrical system and export to the utility grid.

- 25 Solar Hot Water Heat Exchanger and Control System**
 - Moves heat energy from the roof top solar thermal collectors to the mechanical room solar heat exchanger. Uses harvested solar thermal energy to heat hot water in the primary tank.

- 26 Drain Water Heat Recovery System**
 - Recovers energy from draining hot water to preheat incoming domestic cold water before it enters the primary water tank.

- 27 LOGIX ICF Blocks**
 - Special block providing R44 insulation. 2 3/4 inches thick on inside, 8 inches thick on outside with 8 inches of reinforced concrete inside of blocks.

- 28 Concrete Flooring**
 - Holds heat in (thermal mass)

ROOF AND BALCONY

- 29 Rubber Tile Roofing**
 - Made out of recycled rubber tires.
- 30 Solar PV Panels (36 on Roof)**
 - 36 panels convert incident sunlight to DC electricity. (6.8 kw capacity)
- 31 Bifacial PV Panels (8 on Railing of Deck)**
 - 8 bifacial panels convert incident and reflected sunlight to DC electricity while providing privacy. (1.5 kw capacity)
- 32 Solar Thermal Panels (2 on Roof)**
 - Uses heat from the sun to heat up the water used in the house.

THE YARD

- 33 Medicinal/Healing Garden**
 - Experience the TIB medicinal/healing garden and discover plants that are herbal and spiritual.
- 34 Outdoor Portable Composting Unit**
 - Compostable items for use in the garden.
- 35 Drip Irrigation**
 - Water is distributed directly onto plants.
- 36 Xeri-scape Landscape**
 - Requires minimal water and maintenance.